

Pin PCB	H	L
BMO	6800	8080

Terminal2	
No.	Pin Name
1	VSS
2	A0(RS)
3	WR
4	RD
5	XCS
6	RST
7	VDD(3.3V)
8	DB0
9	DB1
10	DB2
11	DB3
12	DB4
13	DB5
14	DB6
15	DB7
16	LED-
17	NO
18	LED+(3.3V)

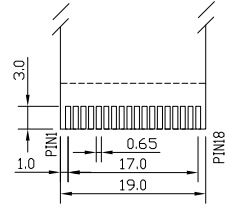

Interface

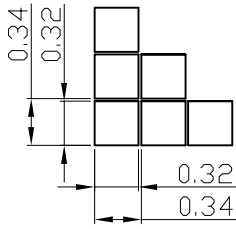

Pixels Details
Scale=18/1

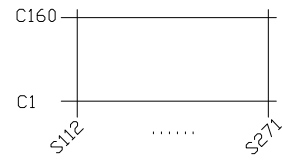

Wiring Details
(Top View)
Scale=12/1

*1. LCD Display Type	FSTN/B&W,Positive,Transflective,		
*2. Viewing Direction	6H	*6. Storage Temp	-30°C~80°C
*3. LCD Driver Mode	1/160Duty,1/10Bias	*7. Driver IC	UC1698
*4. Operating Voltage	3.3V	*8. Backlight	White
*5. Operating Temp	-20°C~70°C	*9. Rose	TBD

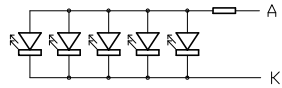

Backlight Circuit
Scale=free

HOT DISPLAY			
Dwg Title: HTM160160E-31W-N3P			
Material No:	10100158	Ver:	A/0
Date:	2013-09-02		
Scale	Unit	Tol.	
1/1	mm	±0.5	
Drawn:	Checked:	Approved:	
Andyi			